

AREAS						CO-ORDINATES								
Erf No.	Square Metres	Erf No.	Square Metres	Erf No.	Square Metres	System Lo = 23°		BLOCK CORNERS						
						Constants	± 0,00 ± 3 760,000,00							
						MAIN FIGURE								
1 Public Place	211	71	566	141	438	A	+ 2 853,37	+12 715,52	99x	+ 2 530,84	+ 13 015,64			
2	666	72	549	142	299	B	+ 2 790,30	+12 728,61	100a	+ 2 498,37	+ 13 004,84			
3	531	73	535	143	282	C	+ 2 629,33	+12 750,74	104a	+ 2 437,00	+ 12 983,87			
4	385	74	554	144	279	D	+ 2 527,89	+12 711,98	107a	+ 2 394,75	+ 12 968,97			
5	443	75	554	145	290	E	+ 2 446,04	+12 713,18	108x	+ 2 381,33	+ 13 003,57			
6	484	76	558	146	281	F	+ 2 403,52	+12 712,37	113c	+ 2 469,25	+ 13 034,17			
7	520	77	551	147	286	G	+ 2 396,28	+12 707,80	115x	+ 2 495,67	+ 13 051,06			
8	495	78	611	148	276	H	+ 2 392,06	+12 699,42	117x	+ 2 482,41	+ 13 063,99			
9	567	79	528	149	290	J	+ 2 379,74	+12 660,11	118x	+ 2 459,27	+ 13 043,60			
10	513	80	515	150	281	K	+ 2 349,07	+12 611,98	123a	+ 2 394,68	+ 13 107,29			
11	574	81	549	151	290	L	+ 2 338,61	+12 575,64	123b	+ 2 381,08	+ 13 121,35			
12	589	82	494	152	318	M	+ 2 307,77	+12 487,95	124c	+ 2 398,51	+ 13 147,04			
13	479	83	419	153	278	N	+ 2 302,27	+12 490,82	129d	+ 2 395,67	+ 13 148,19			
14	492	84	357	154	293	P	+ 2 293,22	+12 479,53	130a	+ 2 379,03	+ 13 124,06			
15	480	85	351	155	283	Q	+ 2 267,97	+12 462,65	136a	+ 2 259,45	+ 13 169,29			
16	451	86	337	156	555	R	+ 2 259,62	+12 466,67	139a	+ 2 207,75	+ 13 190,25			
17	425	87	309	157	275	S	+ 2 051,27	+13 387,90	140x	+ 2 162,93	+ 13 205,26			
18	419	88	285	158	270	T	+ 2 581,11	+13 027,02	141x	+ 2 172,87	+ 13 236,00			
19	432	89	366	159	266	U	+ 2 580,14	+13 005,33	143c	+ 2 220,00	+ 13 218,62			
20	409	90 Public Place	961	160	600	V	+ 2 594,95	+12 980,60	146c	+ 2 269,59	+ 13 198,36			
21	383	91	356	161 Public Place	600	W	+ 2 863,22	+12 772,24	150c	+ 2 337,29	+ 13 171,89			
22	351	92	290	162	491				152x	+ 2 451,67	+ 13 040,23			
23	315	93	306	163	457				155a	+ 2 382,56	+ 13 015,47			
24	317	94	329	164	479				156a	+ 2 364,14	+ 13 010,26			
25	310	95	353	165	489				156c	+ 2 373,18	+ 13 044,33			
26	334	96	363	166	505				161b	+ 2 331,57	+ 13 011,82			
27	337	97	336	167	510				161t	+ 2 296,35	+ 13 050,17			
28	499	98	430	168	506				161u	+ 2 350,63	+ 13 036,53			
29	395	99	322	169	537				162b	+ 2 272,54	+ 13 029,09			
30	271	100	445	170	678				163a	+ 2 260,75	+ 13 039,27			
31	517	101	293	171 Public Place	606				164a	+ 2 252,23	+ 13 053,70			
32	512	102	267	172	747				170b	+ 2 202,28	+ 13 155,11			
33	443	103	279	173	403				171b	+ 2 180,54	+ 13 180,38			
34	477	104	271	174	387				171c	+ 2 182,13	+ 13 185,12			
35	468	105	271	175	553				171d	+ 2 203,24	+ 13 178,05			
36	466	106	278	176	601				171e	+ 2 228,01	+ 13 168,01			
37	521	107	267	177	695				172c	+ 2 232,42	+ 13 170,22			
38	487	108	273	178	454				175a	+ 2 314,26	+ 13 106,72			
39	456	109	291	179	376				178c	+ 2 358,84	+ 13 123,97			
40	403	110	302	180	421				179a	+ 2 359,20	+ 13 086,32			
41	539	111	291	181	333				179d	+ 2 375,90	+ 13 114,78			
42 Public Place	3 379	112	303	182	308				179x	+ 2 391,34	+ 13 099,70			
43 Public Place	1 829	113	319	183	346				180d	+ 2 367,54	+ 13 080,52			
44	1,0789 Ha.	114	259	184	292				180e	+ 2 380,66	+ 13 085,68			
45	483	115	189	185	325				180f	+ 2 383,05	+ 13 092,10			
46	481	116	284	186	401				180x	+ 2 394,85	+ 13 096,12			
47	464	117	295	187	362				181x	+ 2 420,57	+ 13 071,25			
48	481	118	268	188	1759				182b	+ 2 375,98	+ 13 072,99			
49	470	119	275	189 Public Place	1,3634 Ha.				183a	+ 2 363,37	+ 13 048,60			
50	425	120	269	190	518				183b	+ 2 360,16	+ 13 066,99			
51	292	121	278	191	587				183d	+ 2 382,59	+ 13 055,50			
52	322	122	273	192	558				184a	+ 2 361,90	+ 13 048,07			
53	572	123	311	193	586				184b	+ 2 344,82	+ 13 051,40			
54	613	124	379	194	602				184d	+ 2 357,61	+ 13 071,29			
55	624	125	291	195	591				187b	+ 2 299,52	+ 13 062,78			
56	569	126	295	196	549				187c	+ 2 307,69	+ 13 086,89			
57	550	127	290	197	564				188c	+ 2 327,12	+ 12 990,69			
58	735	128	286	198	523				188d	+ 2 371,64	+ 13 000,48			
59	1,5524 Ha.	129	362	199	525				188e	+ 2 380,16	+ 12 961,79			
60	500	130	290	200	598				189b	+ 2 270,79	+ 13 008,52			
61	516	131	277	201	556				189c	+ 2 304,84	+ 13 013,61			
62	538	132	373	202	514				189g	+ 2 361,61	+ 12 957,70			
63	434	133	391	203	440				189h	+ 2 372,59	+ 12 868,28			
64	503	134	270	204	474				189w	+ 2 344,37	+ 12 635,67			
65	1482	135	269	205	457				190d	+ 2 409,35	+ 12 867,19			
66	502	136	277	206	469				190e	+ 2 412,06	+ 12 859,05			
67	510	137	269	207	445				197a	+ 2 388,34	+ 12 720,97			
68	504	138	283	208	818				198a	+ 2 379,97	+ 12 704,31			
69	533	139	290	209	1,9229 Ha.				200a	+ 2 362,86	+ 12 665,90			
70	524	140	489	210	2,3213 Ha.				200e	+ 2 369,35	+ 12 670,42			



BUFFALO BAY ALLOTMENT AREA
T.P.
GENERAL PLAN No. 9939
of
Buffalo Bay Township

Comprising 203 Erfen designated Erven 2- 41, 44-89,
 91- 160, 162- 170, 172- 188 and 190- 210 and 7 Pu-
 blic Places designated Erven 1, 42, 43, 90, 161, 171 and
 189 and streets situate on
 * ERF 215 BUFFALO BAY
 * Portion 4 (a portion of Portion 1) of the farm Walkers Point No. 215
 Buffalo Bay Local Area
ADMINISTRATIVE DISTRICT OF KNYSNA
PROVINCE OF THE CAPE OF GOOD HOPE
 vide diagram No. 7412/77 annexed to DIT 1878- 17897

Scale 1 : 500

Description of Beacons

- S Concrete beacon 300mm. x 300 mm. proj. 550 mm. set on top of rock.
- 188b, 188c, 188d, 188e 20 mm. iron peg.
- 44x No beacon.
- RM 1 - RM 9 12 mm. iron peg below surface.
- All other beacons 12 mm. iron peg.

BLOCK CORNERS		
201d	+ 2 337,09	+ 12 617,38
202a	+ 2 326,22	+ 12 578,60
203a	+ 2 320,26	+ 12 562,86
204a	+ 2 315,16	+ 12 545,12
205a	+ 2 308,18	+ 12 528,31
206a	+ 2 304,27	+ 12 508,74
206e	+ 2 309,05	+ 12 523,78
207a	+ 2 296,80	+ 12 493,67
208a	+ 2 146,21	+ 13 189,54
209f	+ 2 166,89	+ 13 245,70
210e	+ 2 508,57	+ 13 073,53
210f	+ 2 491,56	+ 13 073,23
210g	+ 2 405,81	+ 13 158,11
210h	+ 2 392,05	+ 13 163,70
210m	+ 2 271,07	+ 13 242,92
210n	+ 2 285,71	+ 13 283,91
210o	+ 2 210,83	+ 13 313,92

REFERENCE MARKS		
RM1	+ 2 248,76	+ 13 219,12
RM2	+ 2 197,59	+ 13 159,69
RM3	+ 2 357,80	+ 13 013,61
RM4	+ 2 495,91	+ 13 075,29
RM5	+ 2 307,41	+ 13 107,48
RM6	+ 2 854,02	+ 12 749,42
RM7	+ 2 645,32	+ 12 812,34
RM8	+ 2 367,85	+ 12 665,65
RM9	+ 2 430,18	+ 12 926,84

▲ Krns 37	+ 2 735,99	+ 12 035,83
▲ Krns 38	+ 186,12	+ 9 945,23

Surveyed in April and October 1974, October - December 1976,
 March and June 1977 by me

J.P. Rawson
 Land Surveyor

Original Diagram No. 7412/77
 Survey Record No. E 1644/77
 File No. S/11881/4
 Compilation AL-2BD (3598)
 ALNE 4451 (m 4436)

ALNE 4452 (m 4437)
 ALNE 4453 (m 4438)
 ALNE 4454 (m 4439)

S.G. No. 7413/77
 Approved

 Surveyor-General
 28-6-78

Sheet No. 1
 This plan comprises 5 sheets.

ADMINISTRATOR'S APPROVAL AF-56/1/35 DATED 1976-3-23
 NOTIFIED AS AN APPROVED TOWNSHIP.
 NOTICE NO. PN. 1171/1978 DATED 24-11-1978
 OFFICIAL GAZETTE NO. 4025

ENDORSEMENTS					
NO.	AMENDMENT	ADDITION	AUTHORITY	INTD.	DATE
1	Closure of a portion of Public Place Erf 161	Erf 213	T/C's Notice dated 1888-06-24 pg. 78 S/11881/4 Consent p 124 dated 1988-05-28 Ref. 18/8/81		11/11/88
2	Portion of Road closed.	Erf 216 vide Dgm. 1636/2013	T/C Notice p 128 dd 2013-05-10 S/11881/4 v1 Consent p 124 dd 2012-01-10		11/11/88 2013-07-16
3	Portion of Public Place Erf 161 closed.	Erf 218	T/C Notice p 178 dd 2016-02-26 S/11881/4 v1 Consent p 172 dd 2015-12-07		11/11/88 2016-04-14
4	closure of P.S. 11881/4 v1 p 287				

S.G. OFFICE NOTES		
1.	Erf 188 Beacons Replaced vide Erf 172 vide Dgm. 6345/93	E. 720/93
2.	Erf 192 Beacons Replaced Vide E 2716/2001	
3.	Erven 183 & 216 included in consol Diagram No. 1637/2013 ; Erf 217	
4.	Erf 65 Framed - Vide Dgm. No. 558/2015	
5.	Erf 64 included in consol vide dgm no. 1559/2015 Erf 224	
6.	Erf 126, beacon replaced to Reg 18(2) see S/11881/4 PG 152 of	

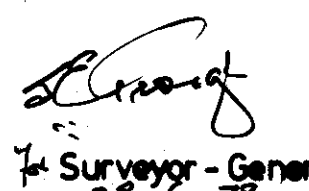
SG. No. 7413/77
 Approved

 Surveyor-General
 28-6-78

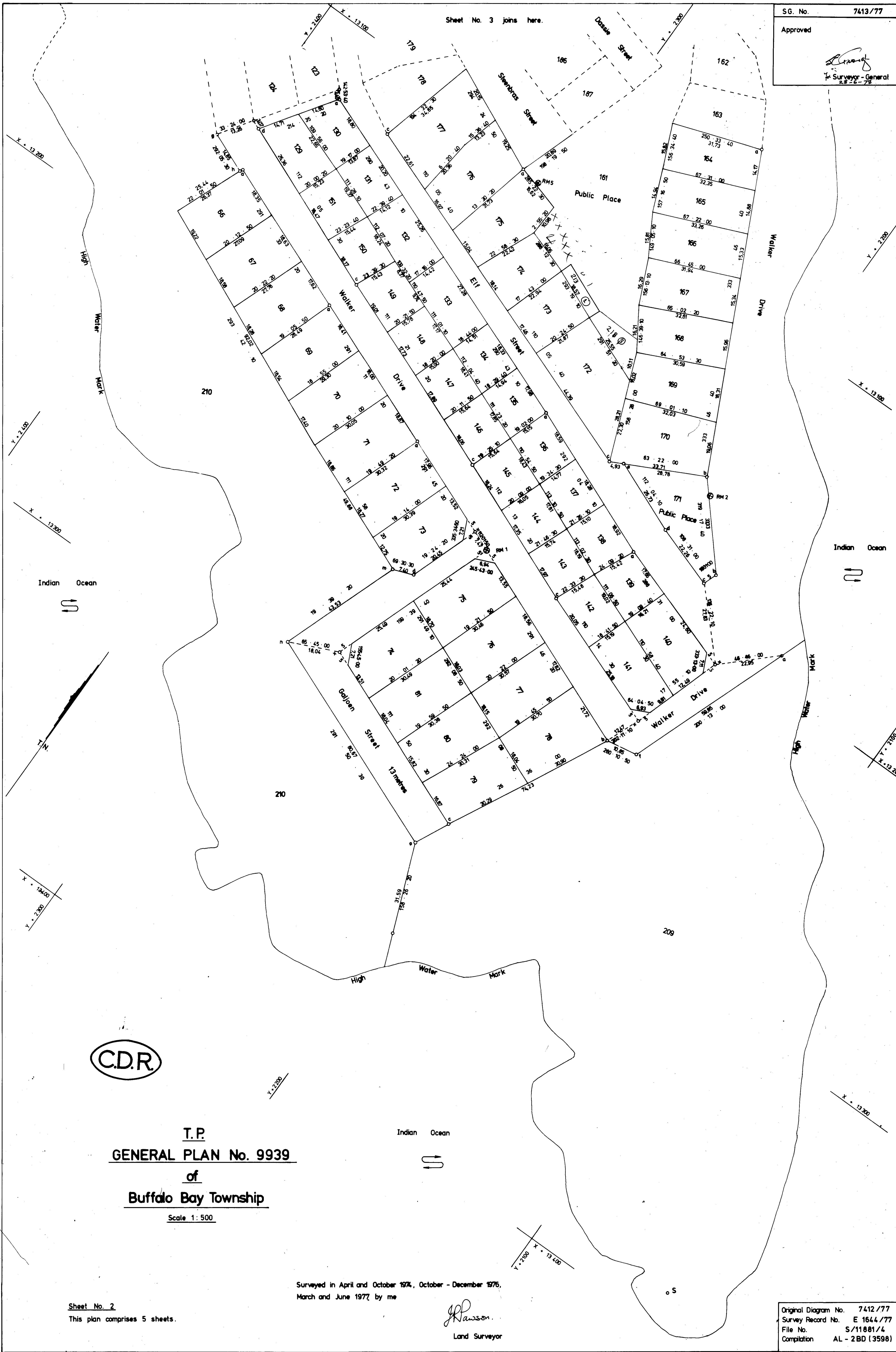
Sheet No. 3 joins here.



C.D.R.

T.P.
GENERAL PLAN No. 9939
of
Buffalo Bay Township
 Scale 1:500

Surveyed in April and October 1974, October - December 1975,
 March and June 1977, by me

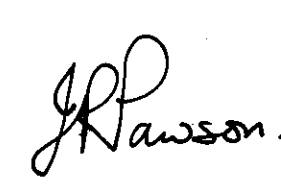
 Land Surveyor

Sheet No. 2
 This plan comprises 5 sheets.

Original Diagram No. 7412/77
 Survey Record No. E 1644/77
 File No. S/11881/4
 Compilation AL - 2BD (3598)

S.G. No. 7413/77
Approved
[Signature]
Surveyor - General
28-6-78

Sheet No. 3
This plan comprises 5 sheets.



T.P.
GENERAL PLAN No. 9939
of
Buffalo Bay Township

Scale 1:500

Surveyed in April and October 1974, October -
December 1976, March and June 1977 by me

J.P. Rawson
Land Surveyor

Original Diagram No. 7412/77
Survey Record No. E 1644/77
File No. S/11081/4
Compilation AL-2 BD (3598)

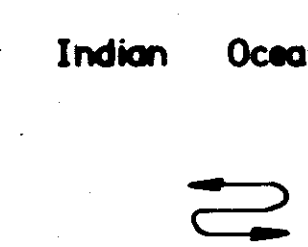
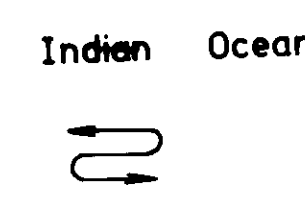
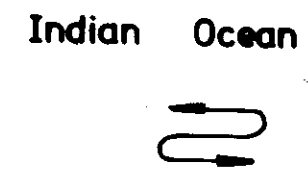
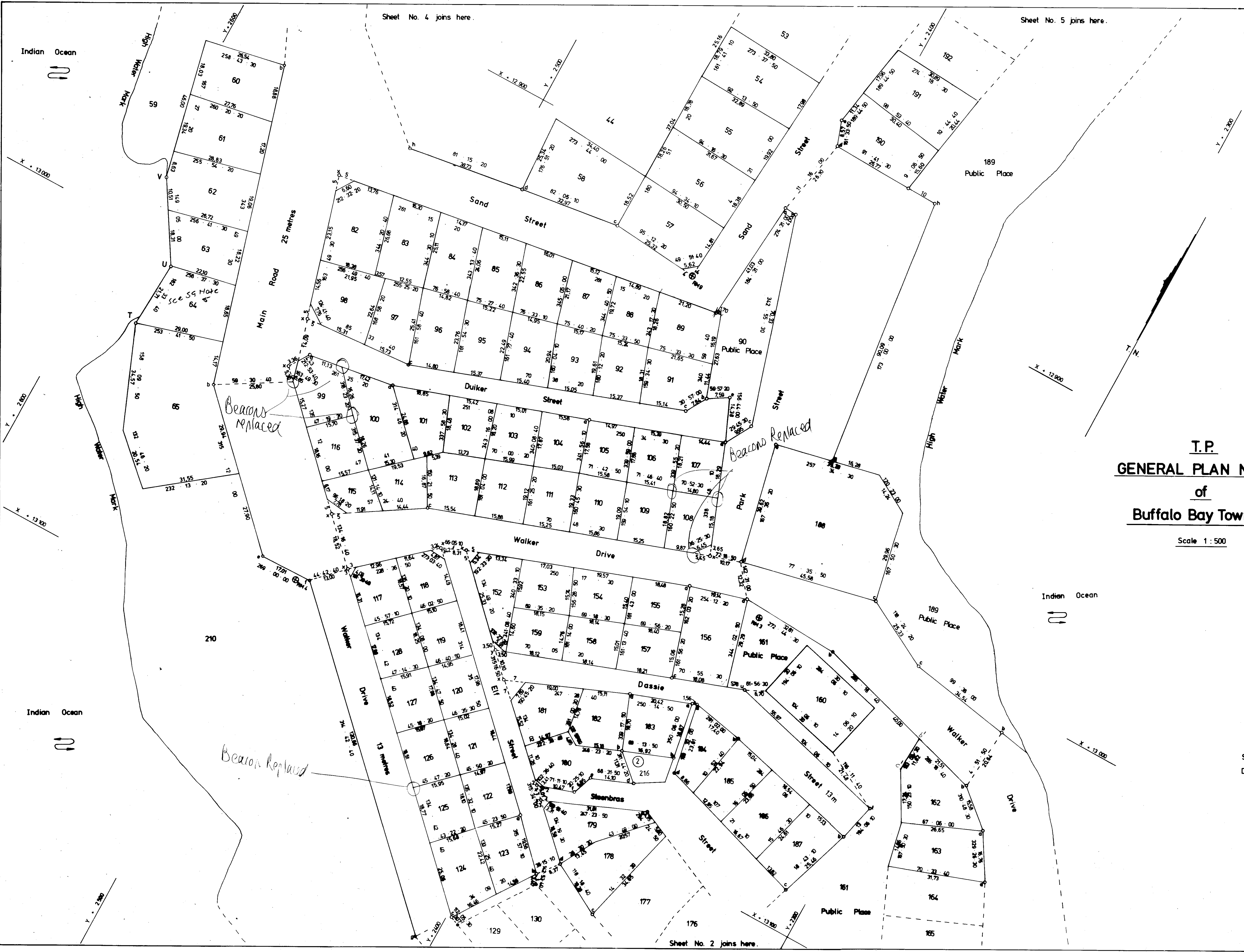

X = 13000

Y = 2800

X = 13000

Y = 2800

Y = 2800

Sheet No. 4 joins here.

Sheet No. 5 joins here.

Sheet No. 2 joins here.

Fig. 2-1-1 (Plan of Place E of 16)

9939 SHT 3

J.R. Rawson
Surveyor - General
28-6-78

Sheet No. 4

This plan comprises 5 sheets.

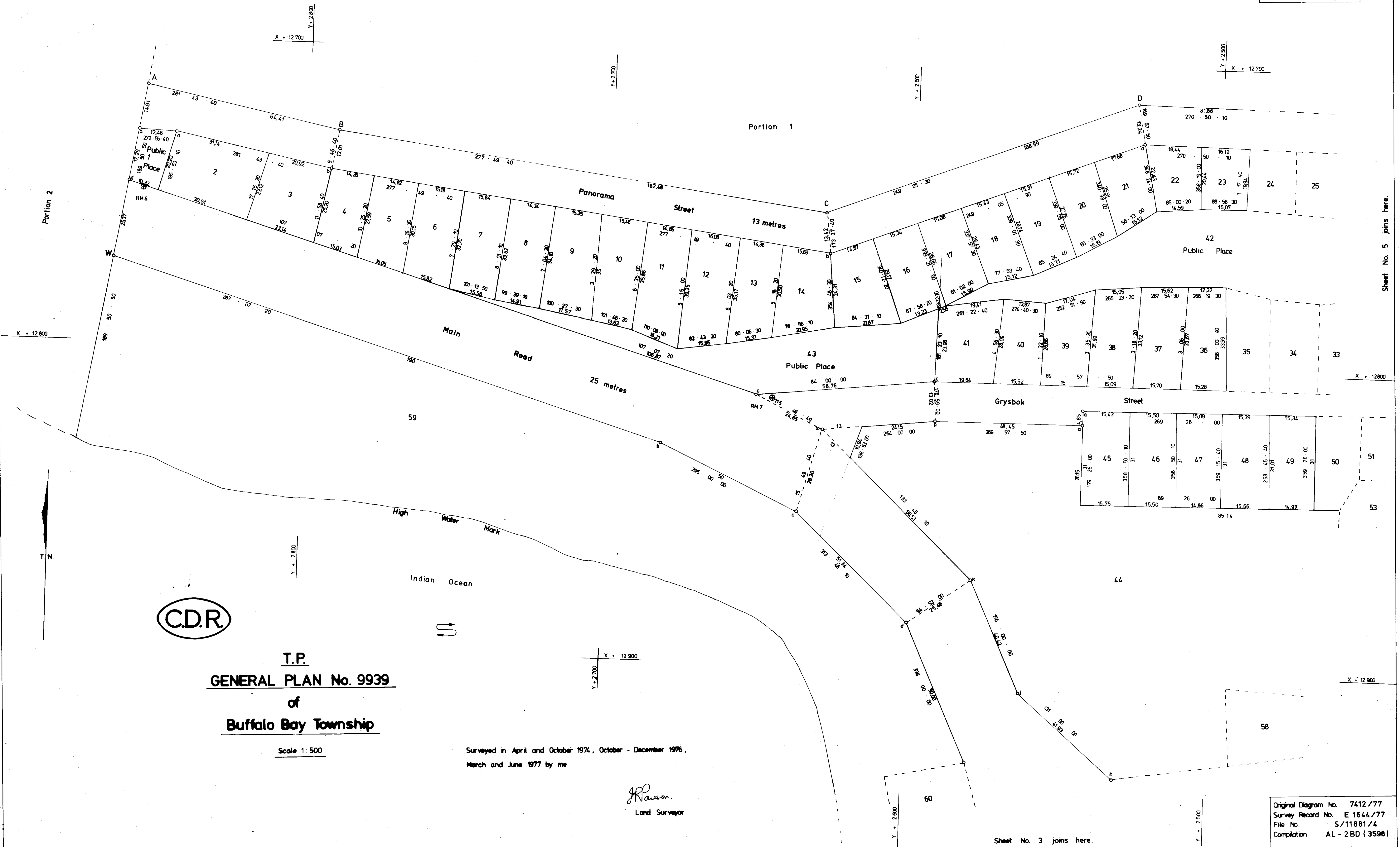

Sheet No. 5 joins here.

Sheet No. 3 joins here.



T.P.
GENERAL PLAN No. 9939
of
Buffalo Bay Township

Scale 1:500

Surveyed in April and October 1974, October - December 1976,
March and June 1977 by me

J.R. Rawson
Land Surveyor

Original Diagram No. 7412/77
 Survey Record No. E 1644/77
 File No. S/11881/4
 Compilation AL - 2BD (3598)

9939 SHT 4

S

Sheet No. 5

This plan comprises 5 sheets.

SG. No. 7413/77

Approved

[Signature]
Surveyor - General
28-6-76

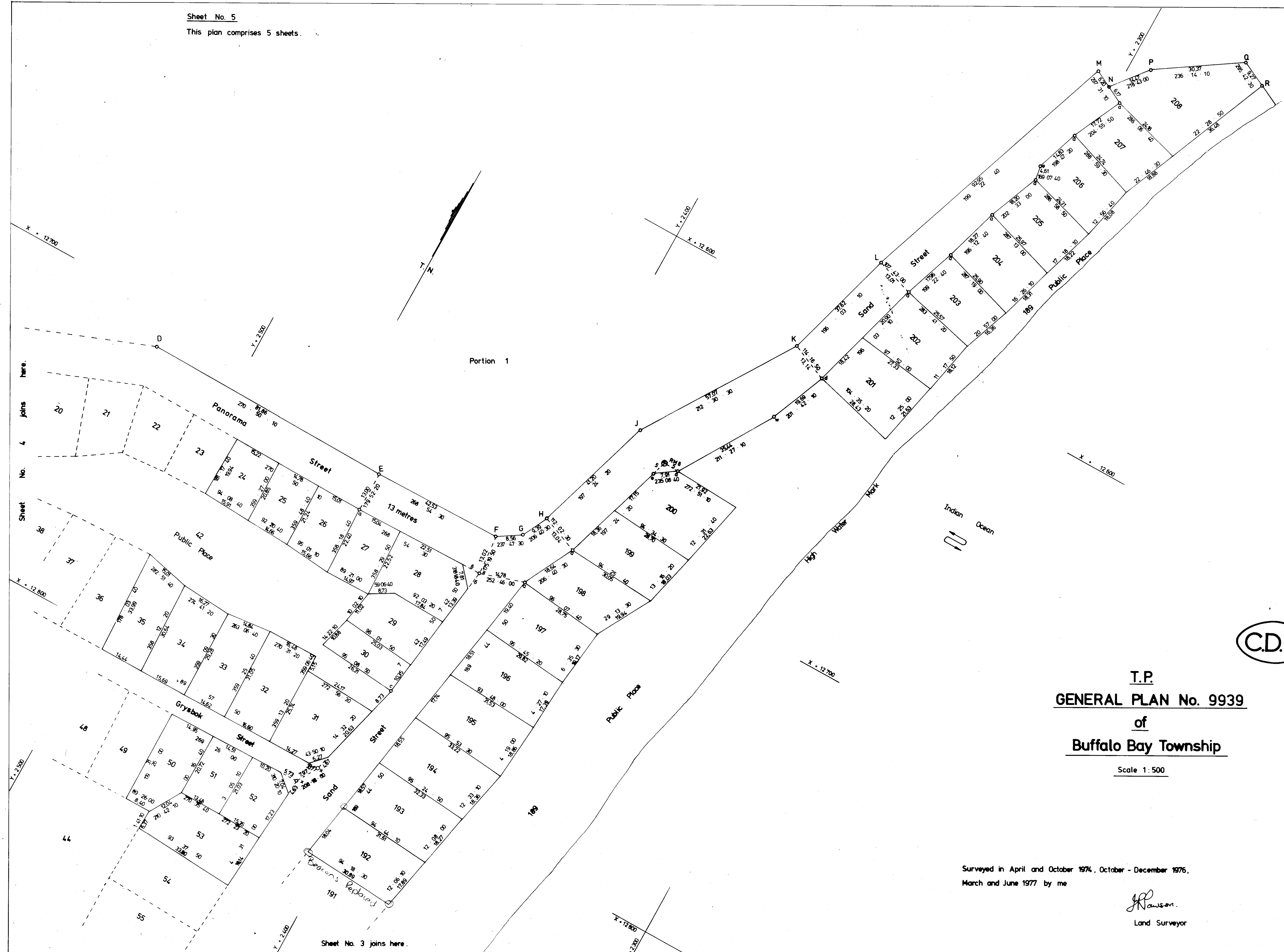

T.P.
GENERAL PLAN No. 9939
 of
Buffalo Bay Township

Scale 1:500

Surveyed in April and October 1974, October - December 1976,
March and June 1977 by me

[Signature]
Land Surveyor

Original Diagram No. 7412/77
 Survey Record No. E1644/77
 File No. 5/11881/4
 Compilation AL - 2 BD (3598)

9939 SHT 5

S