



KNYSNA

Municipality Munisipaliteit uMasipala

Collab. Ref.: 710515

File Ref.: 4982SED

1632SED

Responsible Official: E Hill

2018-05-29

VPM Planning

PO Box 173

KNYSNA

6570

ATTENTION: MS L BOTHA

Dear Madam

ERF 4982 (PORTION OF ERF 1632) SEDGEFIELD: PROPOSED SUBDIVISION PLAN

Your application in the above regard dated 2 November 2013, read with the Municipal Manager's letter of 24 August 2017, refers.

Approval is hereby granted in terms of Section 25 of the Land Use Planning Ordinance, 1985 (Ord. No. 15 of 1985) for the subdivision of Erf 4982 Sedgefield into six (6) "Special Residential" erven and one (1) "Private Open Space erf, as indicated on Drawing No. S4982rev 2 dated 23 May 2018 (which is an update correcting Drawing No. S4982 dated 1 November 2013).

This approval is subject to the conditions included in the approval letter of 10 January 2008, read with, *inter alia*, those of 10 October 2011, 30 March 2012 and 12 April 2012, insofar as they apply to this subdivision, being adhered to and proof thereof being presented to the Municipality prior to application for transfer of the first erf.

This approval may not be construed as authority to deviate from other legal prescriptions or requirements.

This decision was taken by the Manager: Town Planning and Building Control under delegation of the Knysna Local Municipal Council of 6 December 2016.

Your attention is drawn to the provisions of Section 16 and/or Section 27 of the Land Use Planning Ordinance, 1985, regarding the lapsing of unutilized land use approvals (2 years in respect of rezoning, 5 years in respect of subdivision).

Should you have any further enquiries, please contact the writer on telephone number: 044-3026341 or via e-mail address: chill@knysna.gov.za.

Yours faithfully



KAM CHETTY
MUNICIPAL MANAGER
/ (ejh)

cc – Director: Technical Services
Director: Finance
Director: Corporate Services

4982SED SUB APPROVAL 2018-05-29

**PROPOSED SUBDIVISION PLAN
SANDPIPER
PHASE 2
SITUATED ON ERF 4982 SEDGEFIELD**

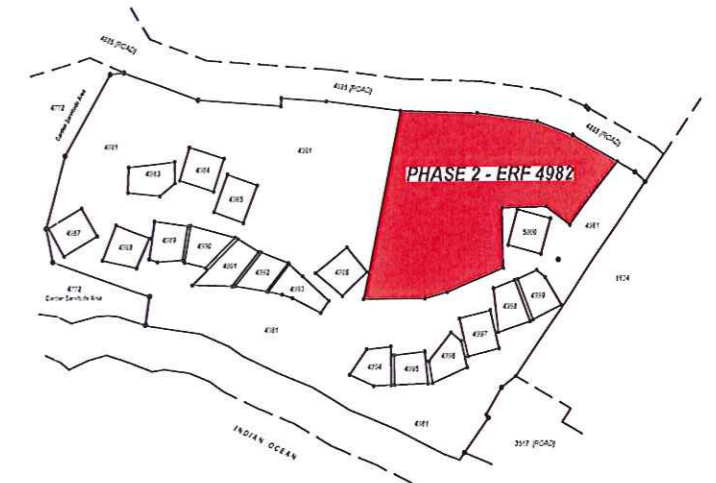

Phase B comprises of 6 Special Zone (Residential) stands and 1 Private Open Space stand

AREAS	
ERF NUMBER	SQUARE METRES
1	494
2	494
3	495
4	498
5	494
6	489
7 (Private open Space)	8574
Total	11 583

NOTES:

Sizes and dimensions are approximate and subject to final survey.

COPY RIGHT:

This plan may not be copied or amended without the written consent of VPM Planning



APPROVED IN TERMS OF SECTION 25 OF ORDINANCE 15 OF 1985

MUNICIPAL MANAGER

DATE: 5/6/2018

SUBDIVISION PLAN

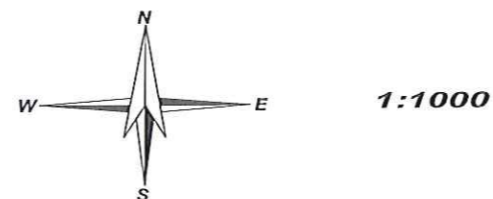

ERF4982 SEDGEFIELD

DRAWN BY : LIZEMARIE BOTHA

DRAWING NR : S4982rev 2

DATE: 23 May 2018