

**SOUTH WEST ELEVATION**  
**Scale 1:100**

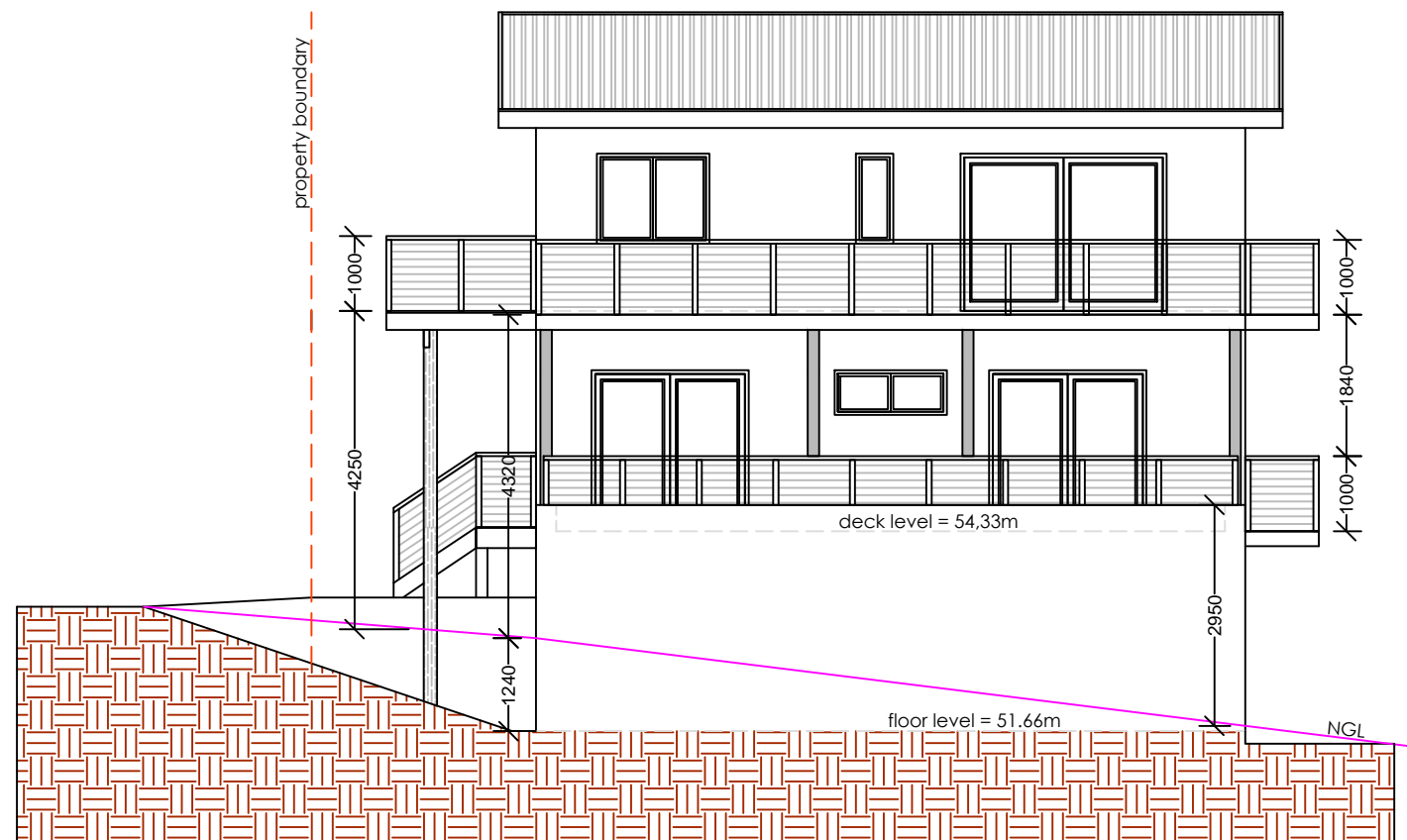

**NORTH WEST ELEVATION**  
**Scale 1:100**

- NOTES :**
1. Drawings may not be scaled.
  2. Any discrepancies on drawings are to be reported to the architect.
  3. All dimensions & levels must be verified on site.
  4. All RC work to be designed by engineers.
  5. All work to be in accordance with SABS, SANS, local building practice, bye-laws, health & fire requirements.
  6. Contractor to advise client of any underground services which are to be avoided or removed & to accept instructions before proceeding.
  7. **TIMBER :**  
All timber to be weather and insect treated and to carry the SABS mark.
  8. **FOUNDATIONS :**  
Foundation walls to be 280mm cavity walls reinforced for the last 5 courses below slab. Cavities to be filled with concrete.
  9. **BRICKLAYER :**  
Foundations to be cast in acceptable soil at min. 600mm below level of virgin ground.  
Min. 100mm surface beds to be cast on well consolidated fill. Apply DPC below all walls, cills, door & window uprights.  
Precast conc. lintols over all windows & doors in accordance with manuf. instructions. Walls to be reinforced every course for 5 courses above openings.
  10. **ELECTRICAL :**  
All electrical work to be tested & approved by Local Electrical Authority.
  11. All plumbing & drainage work & installation of sanitary fittings to comply with relevant Local Authority bye-laws, regs & requirements. Min. falls to drain pipes to 1 : 60.  
Provide approved reseal traps to all waste fittings. Provide IE's at foot of all soil stacks. IE's to waste pipes to be fully accessible at all times. All soil pipes passing under buildings or footings to be encased in concrete of min. 100mm thickness all round pipe.
  12. Any changes to approved plans, must be submitted to local authority for approval.

**N.GENADE**  
**ARCHITECTURAL**  
**DRAUGHTING & DESIGN**  
**SERVICES**

PO BOX 346  
 KNYSNA 6570  
 CELL : 082 215 7709  
 TEL : 044-3822673  
 FAX : 044-3825086  
 E.MAIL : ngenade@gmail.com

DRAWINGS: N.GENADE  
 REG. NO. D0049

PROJECT  
**PROPOSED NEW DWELLING**  
**ERF 120**  
**ELF STREET**  
**BUFFALO BAY , KNYSNA**

CLIENT  
**D & L TERBLANCHE**

TITLE  
**ELEVATIONS**

SCALE  
**1:100**

DRW. NO.	REV.	DATE
N001/03/2022	01	06-04-2022