



**WITBANK OFFICE**

Proffice Building, First Floor, Unit 19  
 23 Corridor Crescent,  
 Benfleure Ext. 11  
 Witbank (Emalahleni), 1035  
 Tel. (013) 653 6375  
 Fax. (013) 653 6376  
 Email: prlbdesigns@gmail.com  
 Website: www.prlbdesigns.co.za  
 P.O. Box 41538, Reyno Ridge, 1049  
 REG NO: CK 2005/070492/23

**PRETORIA OFFICE**

The Village Office Park, First Floor  
 Block D, Cnr Glenwood Road &  
 Oberon Avenue, Faerie Glen  
 Pretoria (Tshwane), 0081  
 Cell. 072 170 6410  
 Fax. 086 604 2173  
 Email: letitia@prlbdesigns.co.za

project description

**AS-BUILT DRAWINGS FOR  
 THE EXISTING DWELLING  
 ON ERF 820, KNYSNA, 41 RIO STREET  
 FOR MR. B VAN ZYL &  
 MR. J.C. VAN ZYL**

drawing description

**BUILDING LINE**

REVISIONS

W.O. No.	DAT.	DESCRIPTION
00	2021-11-08	issued to local authority

RESPONSIBLE PERSON	DATE	ARCHITECTURAL PROFESSIONAL
DESIGNED	LDS Warnich	11/21
DRAWN	LDS Warnich	11/21
CHECKED	L Badenhorst-v.Zyl	11/21
CONTACT	L Badenhorst-Van Zyl	SIGNATURE

drawing no. <b>1451/MD/03</b>	revision <b>00</b>
----------------------------------	-----------------------

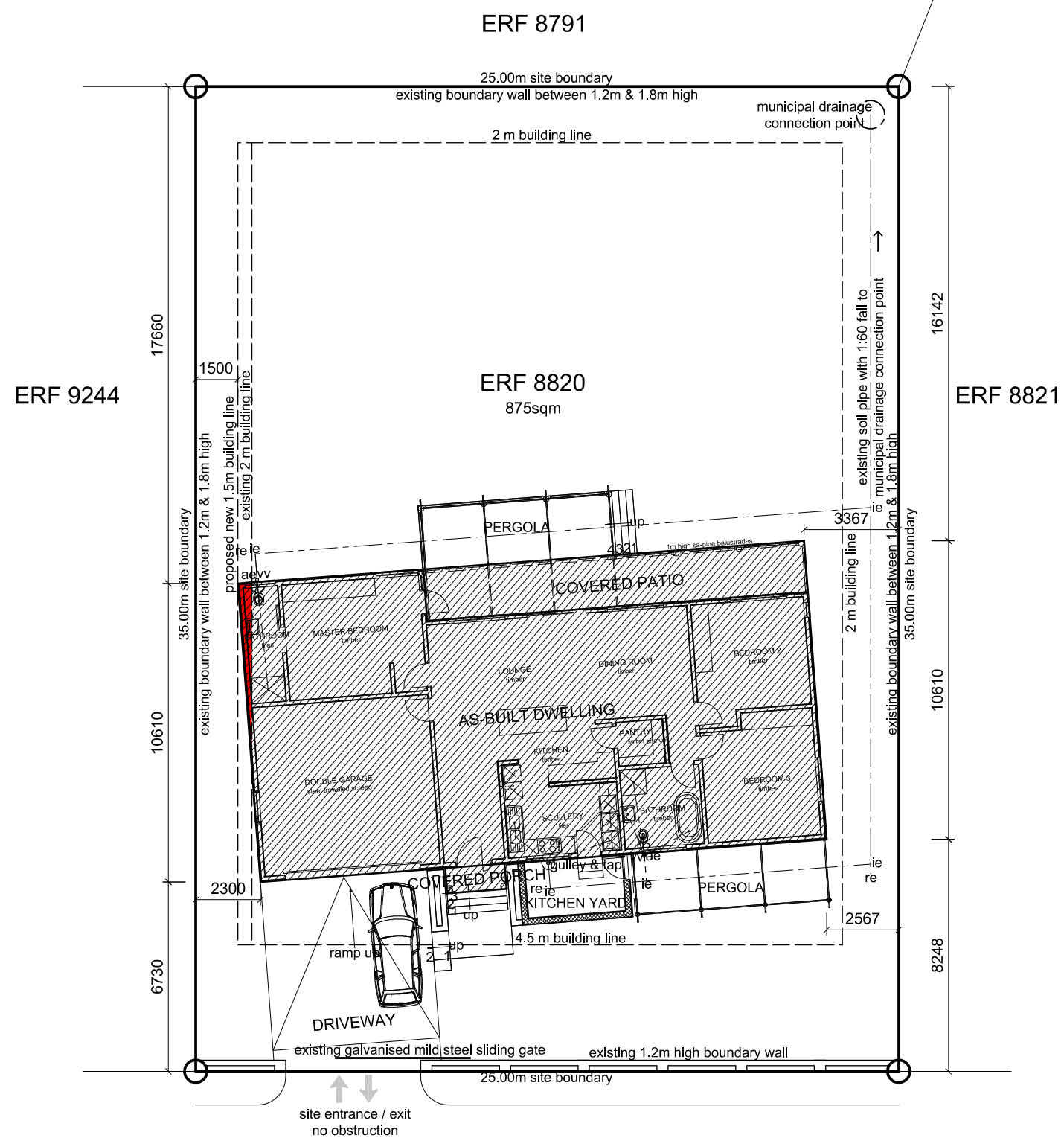

**SITE PLAN** 41 RIO STREET  
 Scale 1:200

**AREA SCHEDULE**

As-built ground floor:	189.97 sq.m
As-built covered patio:	24.85 sq.m
As-built covered porch:	1.90 sq.m
<b>TOTAL BUILDING AREA:</b>	<b>216.72 sq.m</b>
Site area:	875 sq.m
Coverage:	24.8 %
Floor area ratio:	0.25
Height:	1 Storey